

40W Constant Current -LS Series

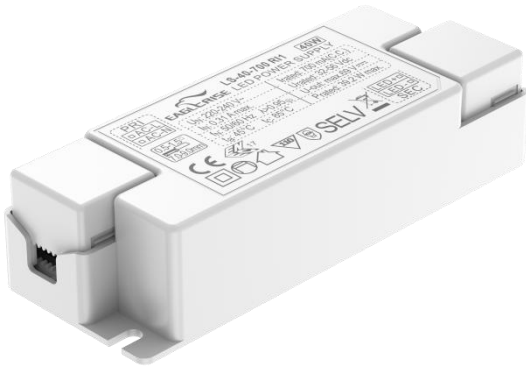

■ Approve



Features

- Class II, SELV, independent
- Input Voltage 220-240VAC
- Protections: SCP/OLP/OVP
- Power Factor 0.95C
- Efficiency $\geq 88\%$
- 5 years warranty

Applications

- LED panel, LED down light
- LED spot light

◆ Description

LS-40-XXX RI1 is a 40W constant current LED driver that operates from 176-264Vac input with 500 to 1050mA output current. With it's compact dimensions from 116 x 42.5 x 28mm it is easy to integrate in LED Panel and down light products. To ensure trouble-free operation, protection is provided against output short circuit and over Load.

◆ Model code

LS-40-XXX RI1

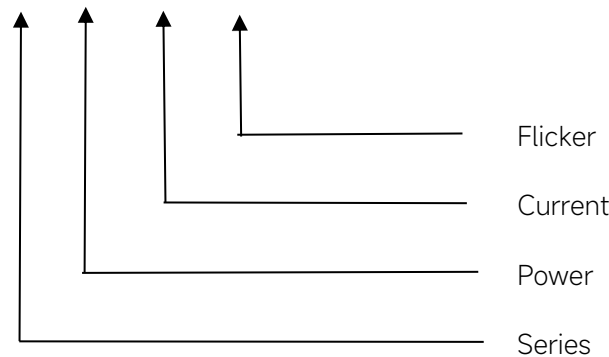

◆ Specification

| | | | | | | |
|-------------|---|--------------------------------|----------|------------|-----|----------|
| Output | Constant Current | 500mA | 700mA | 900mA | ... | 1050mA |
| | Voltage Range | 48-80VDC | 32-56VDC | 25-44.5VDC | ... | 23-40VDC |
| | Unload voltage Max. | 90VDC | 63VDC | 54VDC | ... | 48VDC |
| | Current Accuracy | ±5% | | | | |
| | Ripple & Noise *Note.2 | ±25% | | | | |
| | Efficiency(Typ.) | 88% | | | | |
| Input | Rated input voltage | 220-240VAC | | | | |
| | Range of input voltage | 176-264VAC | | | | |
| | Frequency(Hz) | 50/60 Hz | | | | |
| | Power Factor | 0.95C | | | | |
| | Input Current max | 0.31A | | | | |
| | Start-up time | < 0.5S | | | | |
| | No Load Power | ≤0.5W | | | | |
| | THD (Typ.) | < 8% | | | | |
| Protection | Over Load Protection | 103-120% YES/Auto Resume | | | | |
| | Over Voltage Protection | > 90VDC | > 63VDC | > 54VDC | ... | > 48VDC |
| | | YES/Auto Resume | | | | |
| | Short circuit Protection | YES/Auto Resume | | | | |
| Environment | Operating Temperature | -20°C~+45°C | | | | |
| | Humidity | 20%-90%RH | | | | |
| | Tc | 85°C | | | | |
| | Storage Temperature | -25°C...+60°C | | | | |
| | Life time | > 50000h@Tc=75°C,230VAC | | | | |
| Surface | Dimension | 116X42.5X28(LXWXH)mm | | | | |
| Standards | EN 61347-1; EN61347-2-13; EN62384; EN55015; EN61000-3-2 ; EN61000-3-3; EN 61547; | | | | | |
| Others | RoHS | RoHS (2011/65/EU) (EU)2015/863 | | | | |
| Note | 1.All parameters NOT specially mentioned are measured at 240VAC input, full load and 25°C of ambient temperature. 2.Ripple & Noise are measured at 20MHz of bandwidth by using a 300mm twisted pair-wire terminated with a 0.1uF & 47 uF parallel capacitor. | | | | | |

◆ Model list

| Model number | Input | | | Output | | | Max. Prated(W) |
|----------------|---------------|-------------|----------------|-----------------------|------------------------------|-------------------------------|----------------|
| | Voltage (VAC) | Current (A) | Frequency (Hz) | Constant current (mA) | Normal working voltage (VDC) | No load working voltage (VDC) | |
| LS-40-500 R11 | 220-240 | 0.31 | 50/60 | 500 | 48-80 | 90 | 40 |
| LS-40-550 R11 | | | | 550 | 43.5-73 | 83 | 40.2 |
| LS-40-600 R11 | | | | 600 | 40-67 | 77 | 40.2 |
| LS-40-650 R11 | | | | 650 | 37-62 | 72 | 40.3 |
| LS-40-700 R11 | | | | 700 | 32-56 | 63 | 39.2 |
| LS-40-750 R11 | | | | 750 | 32-53.5 | 63 | 40.1 |
| LS-40-800 R11 | | | | 800 | 30-50 | 60 | 40 |
| LS-40-850 R11 | | | | 850 | 28.5-47.5 | 58 | 40.4 |
| LS-40-900 R11 | | | | 900 | 25-44.5 | 54 | 40.1 |
| LS-40-950 R11 | | | | 950 | 25-42 | 50 | 39.9 |
| LS-40-1000 R11 | | | | 1000 | 24-40 | 50 | 40 |
| LS-40-1050 R11 | | | | 1050 | 23-40 | 48 | 42 |

◆ Wiring diagram

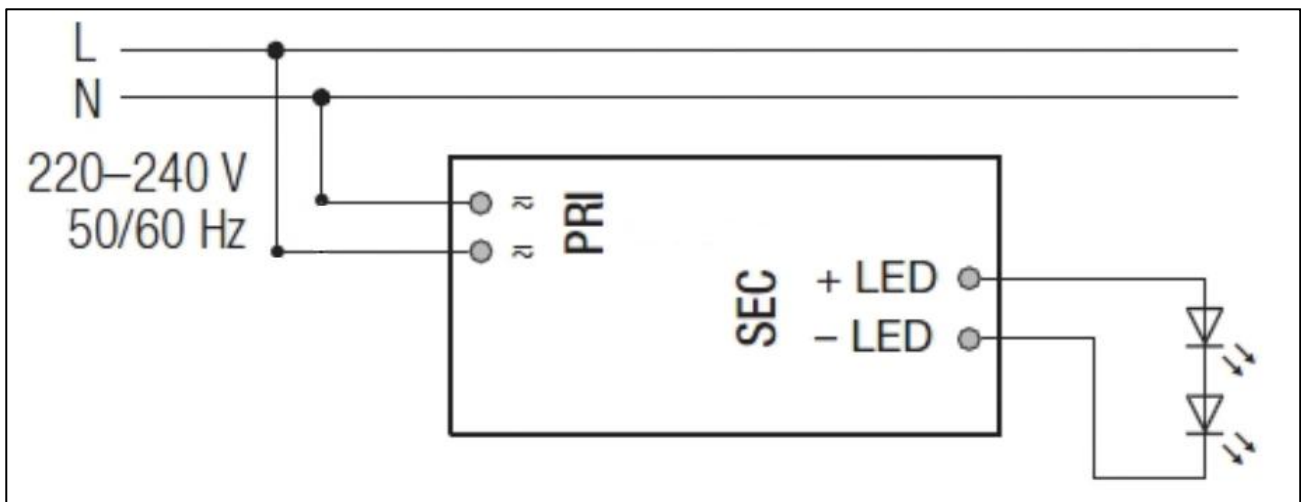

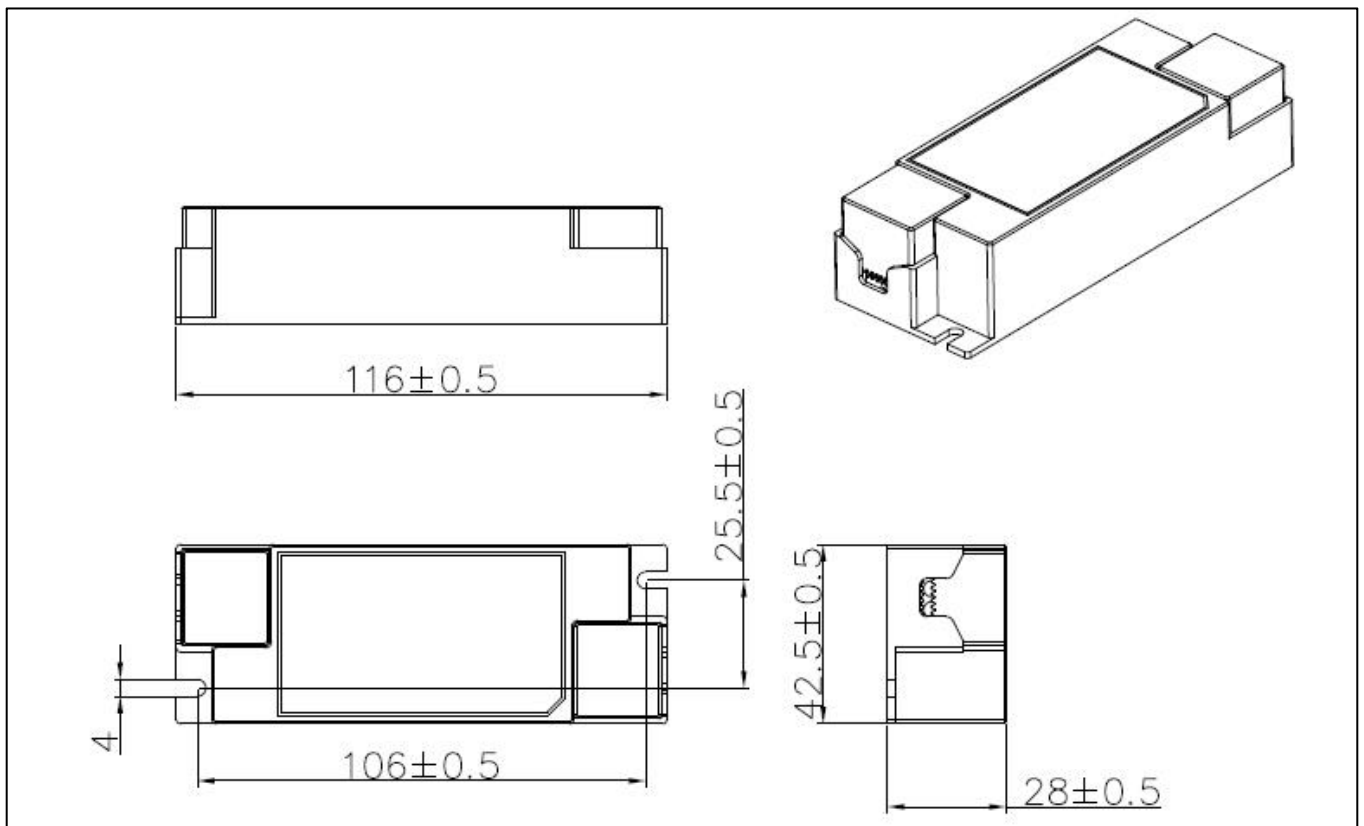
◆ 2D diagram

◆ Wiring & Connections

| | Specification item | Value (Unit) |
|--------|---------------------------|---------------------------|
| Input | Input wire cross-section | 0.5...1.5 mm ² |
| | Input wire gauge. | 16...20 AWG |
| | Input wire strip length | 7...9mm |
| Output | Output wire cross-section | 0.5...1.5 mm ² |
| | Output wire gauge. | 16...20 AWG |
| | Output wire strip length | 7...9mm |

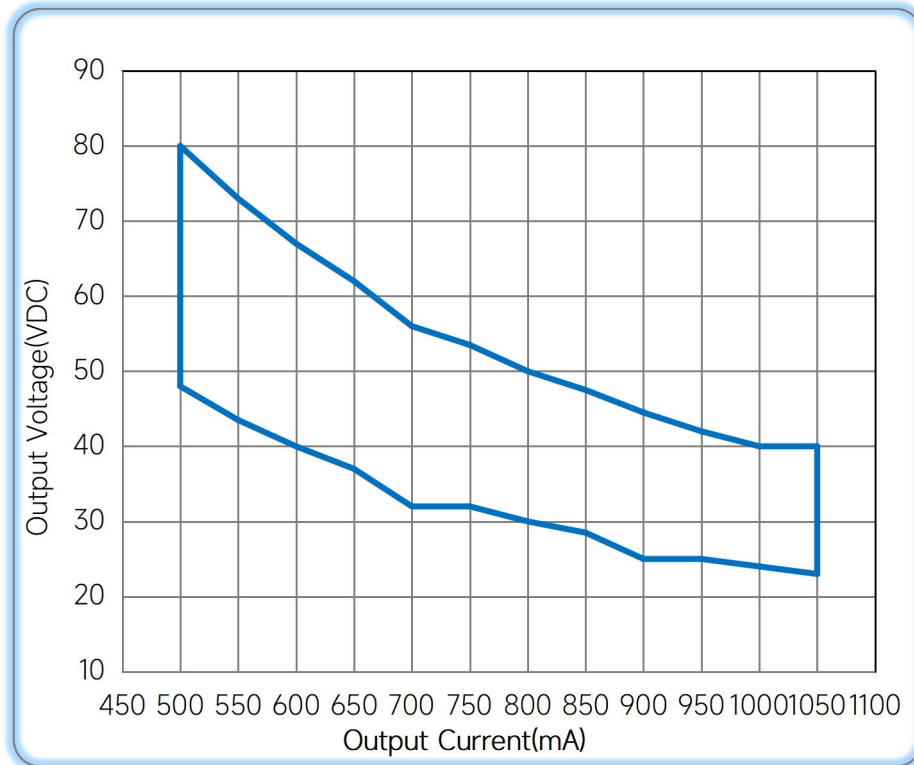
◆ Operating window



— Operating window 100%

◆ Revision Updates

| ITEM | BEFORE | AFTER | VERSION | DATE |
|---------|--------|-------|---------|------------|
| Initial | | | A | 2022/05/15 |
| | | | | |

Tel: +86-0757-86256822, +86-0757-86256831

E-mail: sales@eaglerise.com

Website : <https://lighting.eaglerise.com>



EAGLERISE



Manual