

## 44W Constant Current DALI2-FLS Series

FLS-44-1050 DALI2 LS1

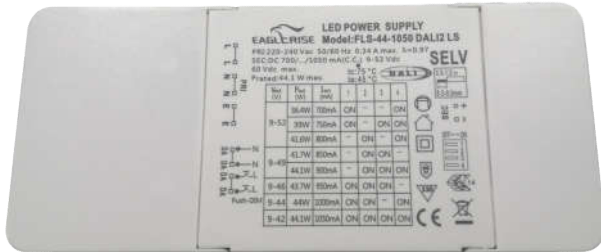

■ Approve

**SELV** **CE**

### ■ Features

- Class II, SELV, independent
- Input Voltage 220-240VAC
- Protections: SCP/OLP/OVP/OTP
- Power Factor >0.95
- Efficiency ≥87%
- 2 Slots
- Support DALI II, Push Dimming
- 5 years warranty

### ■ Applications(Typ.)

- LED strips
- LED panel
- Spot light
- Down light

### ■ Description

FLS-44-1050 DALI2 LS1 is a 44W constant current, 2 slots LED driver with 700 to 1050mA output current and a forward voltage range from 9 to 52Vdc. The output current is selectable by DIP Switch. With it's dimensions from 180 x 80 x 30mm it is easy to integrate in LED Panel, spot and down light products. To ensure trouble-free operation, protection is provided against output short circuit and over Load.

### ■ Model code

FLS-44-1050 DALI2 LS1

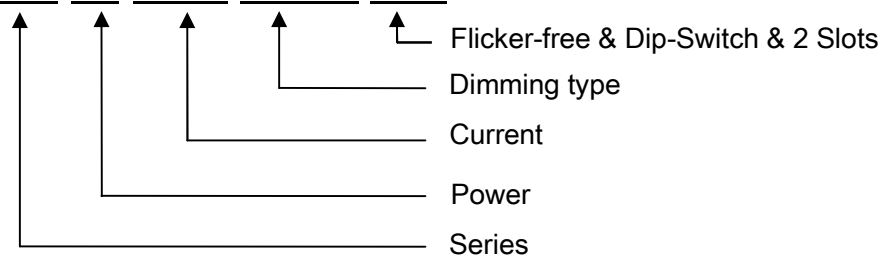

## 44W Constant Current DALI2-FLS Series

FLS-44-1050 DALI2 LS1

### ■ Specification

Input	Rated input voltage	220-240VAC
	Range of input voltage	198-264VAC
	Rated input voltage(DC)	198-254V
	DC voltage range	176-280V
	Frequency(Hz)	0/50/60 Hz
	Power Factor	>0.95@220-240VAC, full load
	Input Current max	0.34A MAX. @Full Load,198VAC
	Start-up time	< 1S
	Unload Power Consumption	≤0.5W
	Inrush Current	20A Max. /45μs@230V, Full Load , 50%Ipk-50%Ipk
	THD	< 10% @Full Load,230VAC , Io=1050mA
	Leakage Current	< 0.7mA(240VAC)
Output	Constant Current	700/.../1050mA
	Unload voltage Max.	60 VDC
	Voltage Range(VDC)	9-52VDC
	Rated power	44.1W Max.
	Current Accuracy	±5% @220-240VAC
	Voltage Regulation	±5% @220-240VAC, full load
	Load Regulation	±5% @220-240VAC
	Hold-up Time	1s max.@Full Load
	Output HF current ripple *Note.2	≤±10% @Full Load,240VAC
	Output LF current ripple(<120Hz)	≤±3% @Full Load,240VAC
Efficiency(Typ.)	≥87%	
Dimming	Dimmable	YES
	Dimming mode	DALI II, Push
	Dimming current range	1%~100%
Protection	Over Load Protection	103-120% Protection type: Latch off
	Over Voltage Protection	> 60VDC Protection type: Latch off
	Short circuit Protection	Protection type: Latch off
	Over Temperature Protection	Protection type: Auto Resume
Environment	Operating Temperature	-20°C...+45°C
	tc	85°C
	Storage Temperature	-25°C...+60°C
	Life time	> 44,000h@ta=45°C,230VAC
	Humidity	20%-90%RH
Others	Dimension	180X80X30(LXWXH)mm
Safety & EMC	Safety standards	EN 61347-1; EN61347-2-13; EN62384
	Withstand voltage	Input-Output : 3750V/5mA/1min
	Isolation resistance	Input-Output : ≥4MΩ@500VDC
	EMI	EN55015; EN61000-3-2 Class C; EN61000-3-3
	EMS	EN 61547; EN 61000-4-2; EN 61000-4-5 —1000V;

## 44W Constant Current DALI2-FLS Series

## FLS-44-1050 DALI2 LS1

Note	1.All parameters NOT specially mentioned are measured at 240VAC input , full load , $I_o=1050\text{mA}$ and $25^\circ\text{C}$ of ambient temperature.
	2.Ripple & Noise are measured at $20\text{MHz}$ of bandwidth by using a $300\text{mm}$ twisted pair-wire terminated with a $0.1\mu\text{F}$ & $47\mu\text{F}$ parallel capacitor.
	3.All parameters marking full load conditions are measured at full load, $V_o=42\text{Vdc}$ , $I_o=1050\text{mA}$ or $P_o\geq 44\text{W}$ .

### Adjustable Output Current with dip-switch

$V_o$	$P_o$	$I_o$	1	2	3
9-52VDC	36.4W	700mA	--	--	--
9-52VDC	39W	750mA	ON	--	--
9-52VDC	41.6W	800mA	--	ON	--
9-49VDC	41.7W	850mA	ON	ON	--
9-49VDC	44.1W	900mA	--	--	ON
9-46VDC	43.7W	950mA	ON	--	ON
9-44VDC	44W	1000mA	--	ON	ON
9-42VDC	44.1W	1050mA	ON	ON	ON

### Wiring diagram

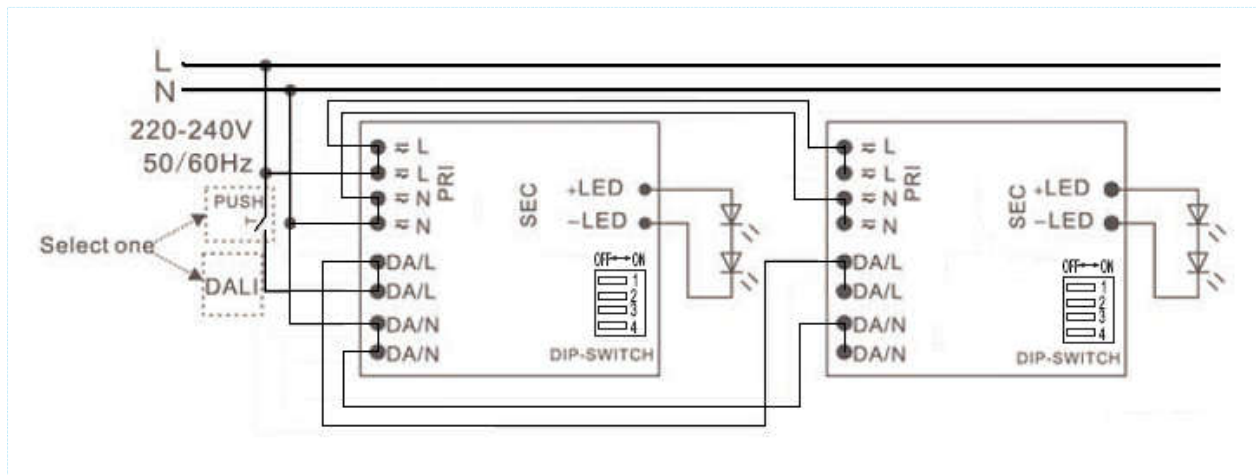

## 44W Constant Current DALI2-FLS Series

### FLS-44-1050 DALI2 LS1

#### ■2D diagram

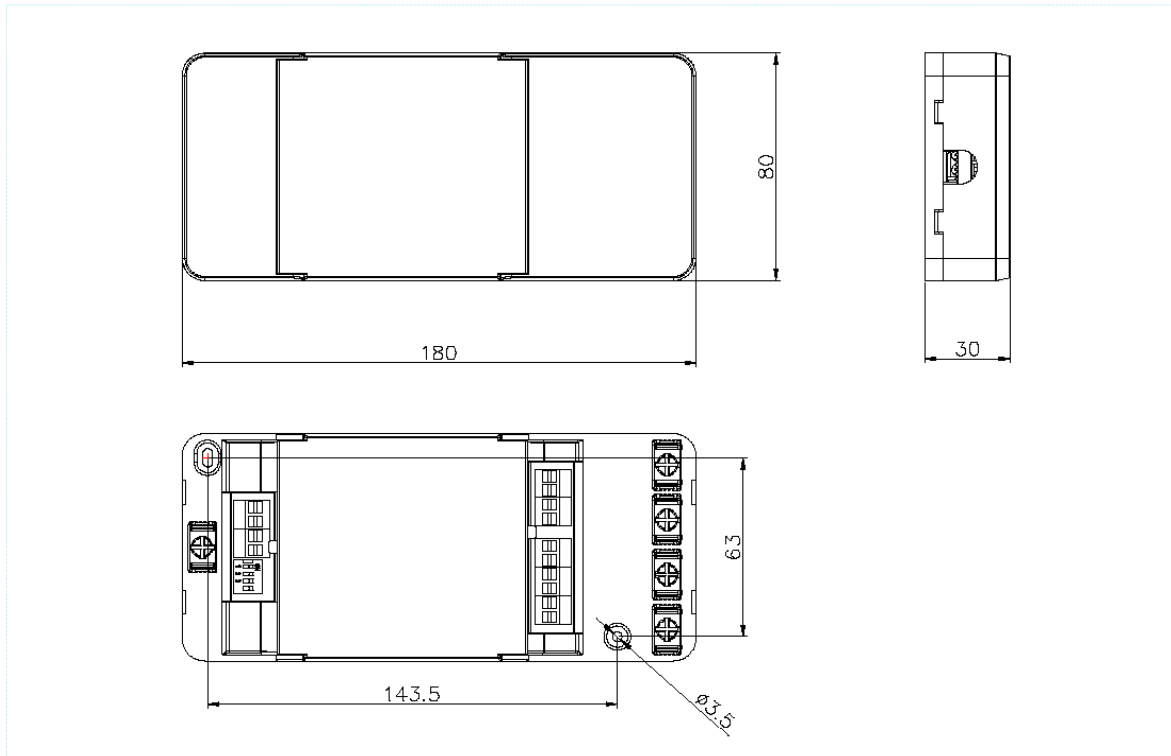

#### ■Curve for FLS-44-1050 DALI2 LS1 , $I_o=1050mA$

##### Lifetime vs. Ambient Temperature Curve

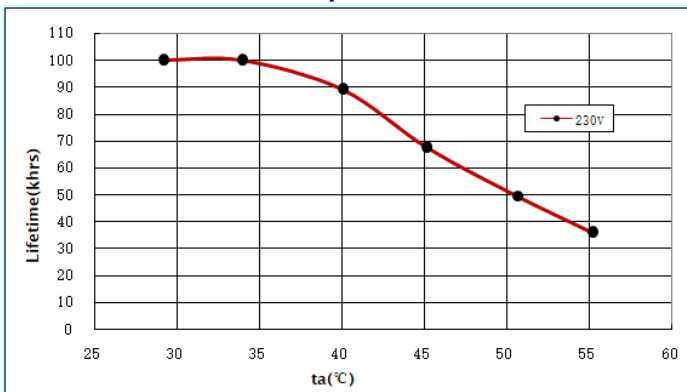

##### Efficiency vs. Load

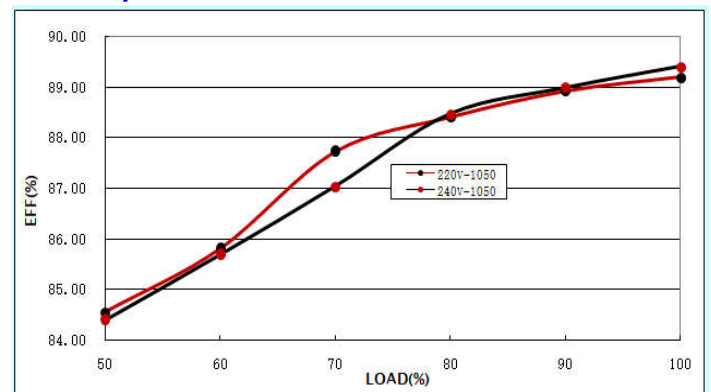

##### Power Factor Characteristics

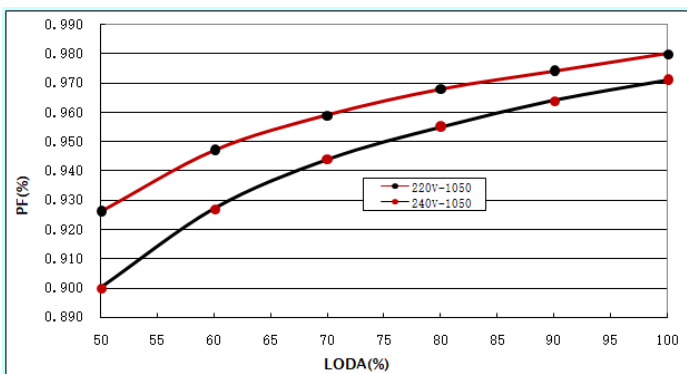

##### THD vs. Load

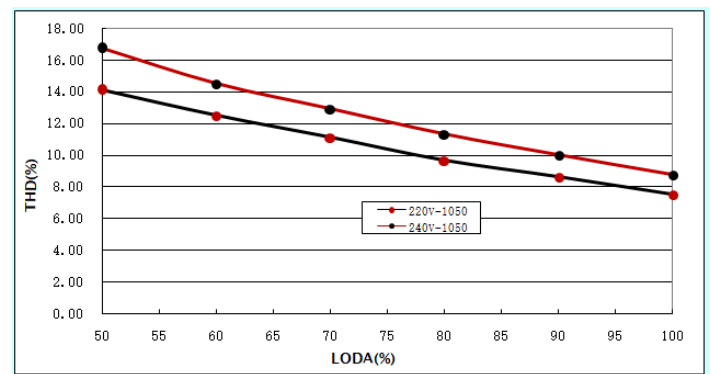

## 44W Constant Current DALI2-FLS Series

FLS-44-1050 DALI2 LS1

### ■ Operating window

