

## 25W Constant Current DALI2-FLS Series

FLS-25-700 DALI2 LS1



■ Approve  
**SELV** **CE**

### ■ Features

- Class II, SELV, independent
- Input Voltage 220-240VAC
- Protections: SCP/OLP/OVP/OTP
- Power Factor >0.95
- Efficiency ≥84%
- 2 Slots
- Support DALI II, Push Dimming
- 5 years warranty

### ■ Applications(Typ.)

- LED strips
- LED panel
- Spot light
- Down light

### ■ Description

FLS-25-700 DALI2 LS1 is a 25W constant current, 2 slots LED driver with 250 to 600mA output current and a forward voltage range from 9 to 42Vdc. The output current is selectable by DIP Switch. With it's dimensions from 180 x 80 x 30mm it is easy to integrate in LED strips, panel, spot and down light products. To ensure trouble-free operation, protection is provided against output short circuit and over Load.

### ■ Model code

FLS-25-700 DALI2 LS1

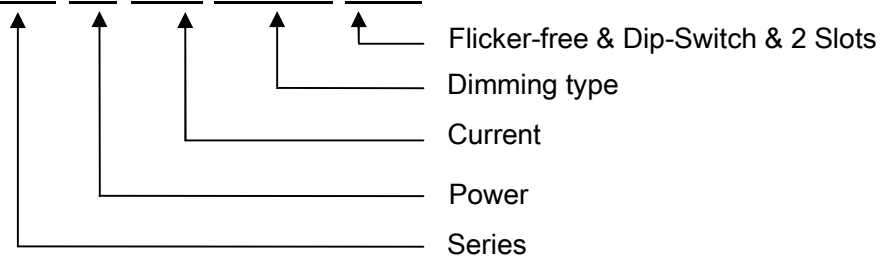

## 25W Constant Current DALI2-FLS Series

FLS-25-700 DALI2 LS1

### ■ Specification

Input	Rated input voltage	220-240VAC
	Range of input voltage	198-264VAC
	Rated input voltage(DC)	198-254V
	DC voltage range	176-280V
	Frequency(Hz)	0/50/60 Hz
	Power Factor	> 0.95@220-240VAC, full load
	Input Current max	0.2A MAX. @Full Load, 198VAC
	Start-up time	< 1S
	Unload Power Consumption	≤0.5W
	Inrush Current	20A Max. /45μs@230V, Full Load , 50%Ipk-50%Ipk
	THD	< 10%@Full Load, 240VAC, I <sub>o</sub> =700mA
	Leakage Current	< 0.7mA(240VAC)
Output	Constant Current Max.	150/.../700mA
	Unload voltage Max.	60 VDC
	Voltage Range(VDC)	9-52VDC
	Rated power	26.3W Max.
	Current Accuracy	I <sub>o</sub> ≤350mA : ±7%@220-240VAC ; I <sub>o</sub> >350mA : ±5%@220-240VAC
	Voltage Regulation	±5% @Full Load, 220-240VAC
	Load Regulation	±5%@220-240VAC
	Hold-up Time	1s max. @Full Load
	Output HF current ripple *Note.2	≤±10% @Full Load, 240VAC
	Output LF current ripple(<120Hz)	≤±3% @Full Load, 240VAC
	Efficiency(Typ.)	≥84%
Dimming	Dimmable	YES
	Dimming mode	DALI II, Push
	Dimming current range	5mA(min) ~100%
Protection	Over Load Protection	103-120% Protection type: Latch off
	Over Voltage Protection	> 60VDC Protection type: Latch off
	Short circuit Protection	Protection type: Latch off
	Over Temperature Protection	Protection type: Auto Resume
Environment	Operating Temperature	-20°C...+45°C
	t <sub>c</sub>	75°C
	Storage Temperature	-25°C...+60°C
	Life time	> 50,000h@t <sub>a</sub> =45°C, 230Vac
	Humidity	20%-90%RH
Others	Dimension	180X80X30(LXWXH)mm
Safety & EMC	Safety standards	EN 61347-1; EN61347-2-13; EN62384
	Withstand voltage	Input-Output : 3750V/5mA/1min
	Isolation resistance	Input-Output : ≥4MΩ@500VDC
	EMI	EN55015; EN61000-3-2 Class C; EN61000-3-3
	EMS	EN 61547; EN 61000-4-2; EN 61000-4-5 —1000V;

## 25W Constant Current DALI2-FLS Series

### FLS-25-700 DALI2 LS1

Note	1.All parameters NOT specially mentioned are measured at 240VAC input , full load and 25°C of ambient temperature.
	2.Ripple & Noise are measured at 20MHz of bandwidth by using a 300mm twisted pair-wire terminated with a 0.1uF & 47 uF parallel capacitor.

#### ■Adjustable Output Current with dip-switch

Vo	Po	Io	1	2	3	4
9-52VDC	7.8W	150mA	--	--	ON	--
9-52VDC	10.4W	200mA	ON	--	ON	--
9-52VDC	13W	250mA	--	ON	ON	--
9-52VDC	15.6W	300mA	ON	ON	ON	--
9-52VDC	18.2W	350mA	--	--	--	ON
9-52VDC	20.8W	400mA	ON	--	--	ON
9-52VDC	23.4W	450mA	--	ON	--	ON
9-52VDC	26W	500mA	ON	ON	--	ON
9-47.5VDC	26.1W	550mA	--	--	ON	ON
9-43.5VDC	26.1W	600mA	ON	--	ON	ON
9-40VDC	26W	650mA	--	ON	ON	ON
9-37.5VDC	26.3W	700mA	ON	ON	ON	ON

#### ■Maximum loading of automatic circuit breakers in relation to inrush current

Automatic circuit breaker type	B10	B13	B16	B20	C10	C13	C16	C20	C32
Installation Ø	1.5mm <sup>2</sup>	1.5mm <sup>2</sup>	1.5mm <sup>2</sup>	1.5mm <sup>2</sup>	1.5mm <sup>2</sup>	1.5mm <sup>2</sup>	1.5mm <sup>2</sup>	1.5mm <sup>2</sup>	1.5mm <sup>2</sup>
FLS-25-700 DALI2 LS1	24	30	36	42	30	37	45	53	53

These are max values calculated out of inrush current! Please consider not to exceed the maximum rated continuous current of the circuit breaker.

Actual values may differ due to used circuit breaker types and installation environment.

## 25W Constant Current DALI2-FLS Series

FLS-25-700 DALI2 LS1

### ■Wiring diagram

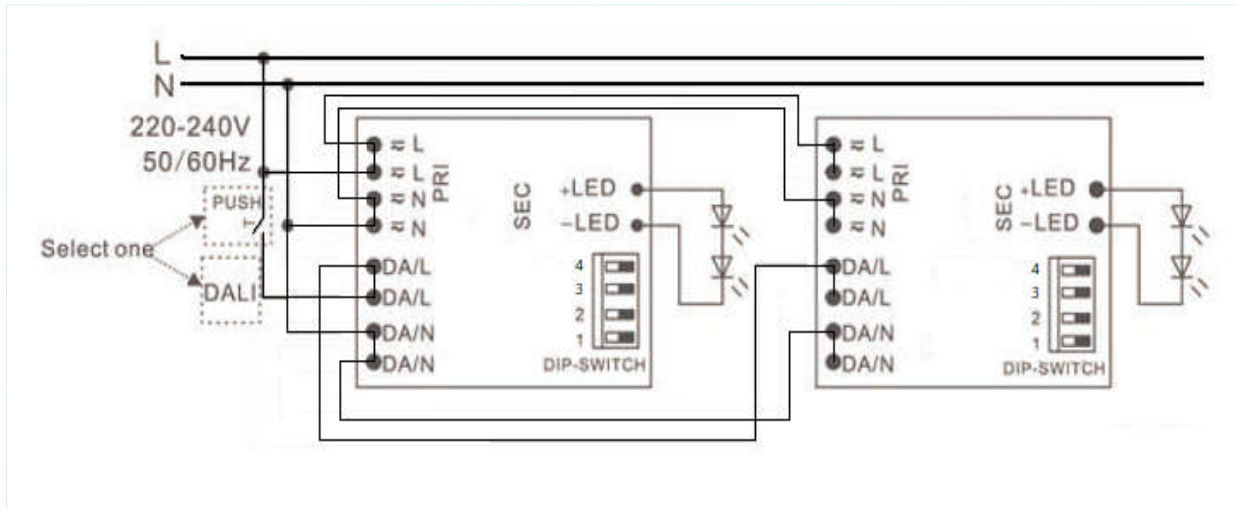

### ■2D diagram

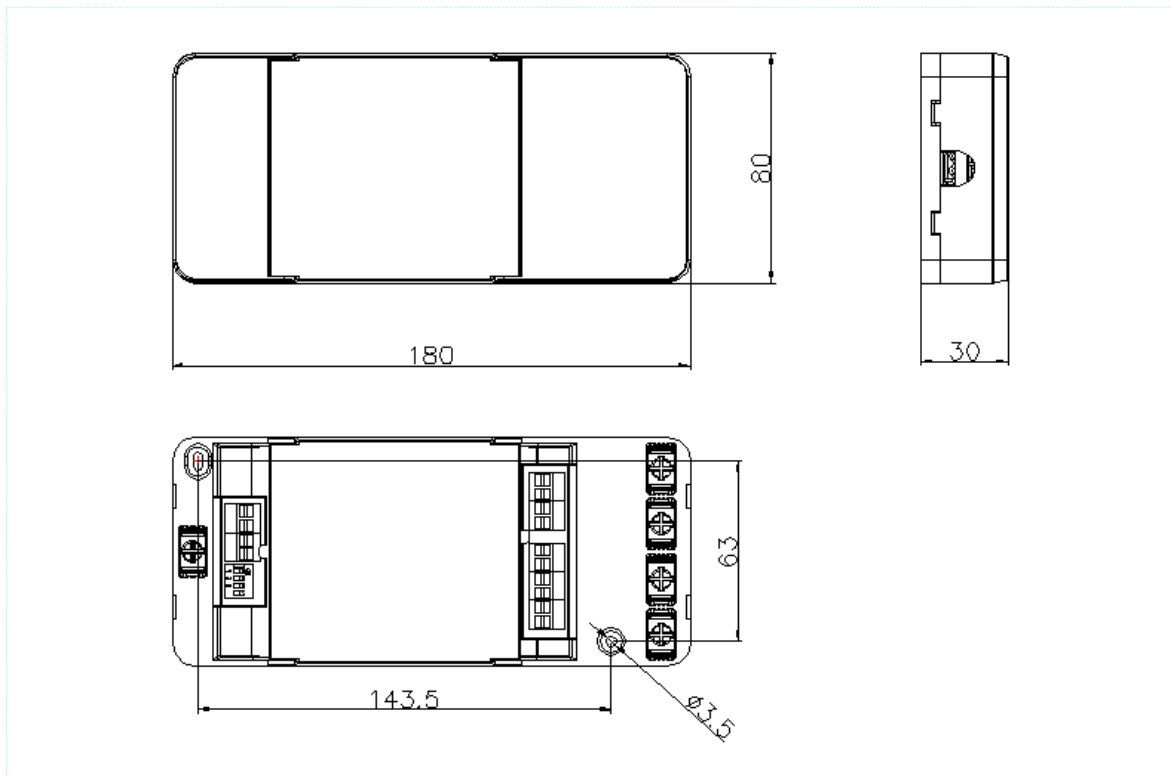

## 25W Constant Current DALI2-FLS Series

### FLS-25-700 DALI2 LS1

#### ■ Curve for FLS-25-700 DALI2 LS1 , I<sub>o</sub>=700mA

##### Lifetime vs. Ambient Temperature Curve

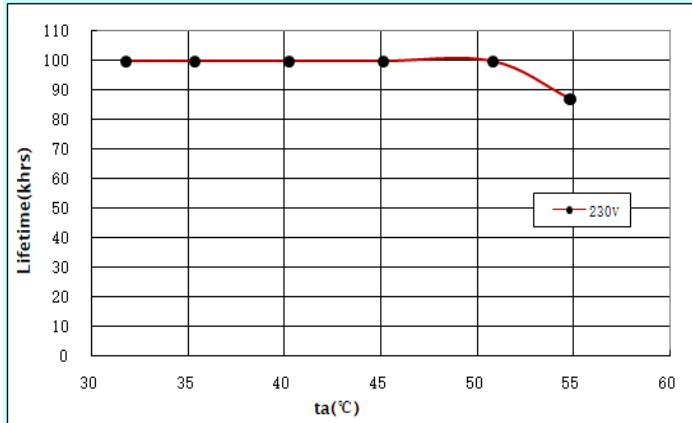

##### Efficiency vs. Load

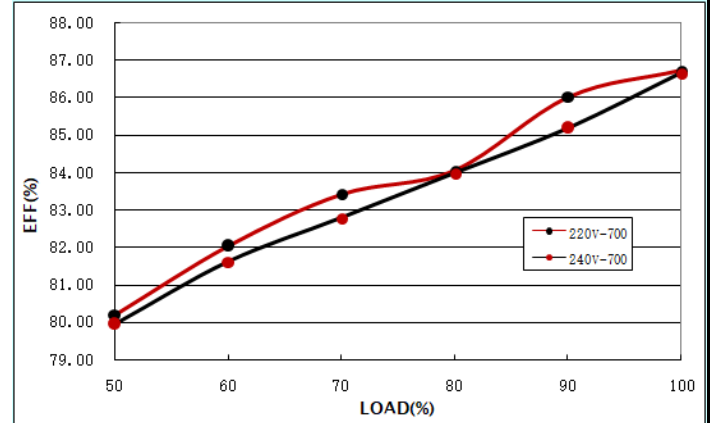

##### Power Factor Characteristics

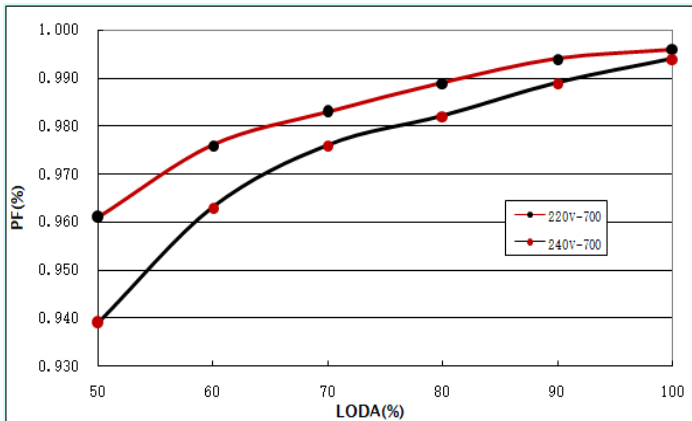

##### THD vs. Load

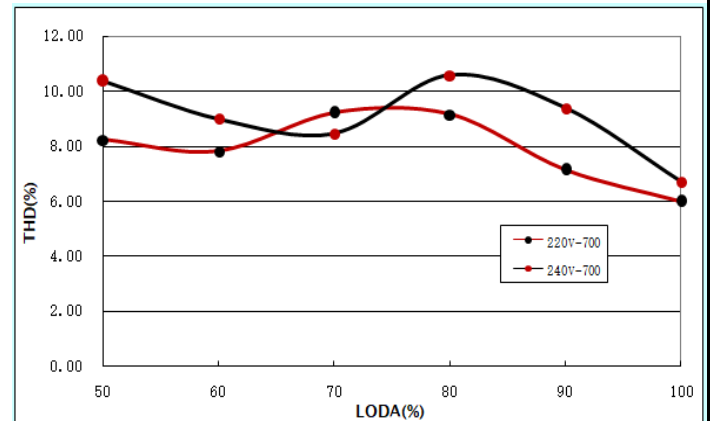

#### ■ Operating window

